

PRODUCT INFORMATION PACKET

Model No: 182TTDBD6026

Catalog No: GT0010A

3 HP General Purpose Motor, 3 phase, 1800 RPM, 208-230/460 V, 182T Frame, ODP
Three Phase ODP Motors



Nameplate Specifications

Output HP	3 Hp	Output KW	2.2 kW
Frequency	60 Hz	Voltage	208-230/460 V
Current	8.6-8.0/4.0 A	Speed	1770 rpm
Service Factor	1.15	Phase	3
Efficiency	89.5 %	Power Factor	77.5
Duty	Continuous	Insulation Class	F
Design Code	A	KVA Code	L
Frame	182T	Enclosure	Drip Proof
Thermal Protection	No	Ambient Temperature	40 °C
Drive End Bearing Size	6206	Opp Drive End Bearing Size	6203
UL	Recognized	CSA	Y
CE	Y	IP Code	22

Technical Specifications

Electrical Type	Squirrel Cage Inverter Rated	Starting Method	Line Or Inverter
Poles	4	Rotation	Reversible
Resistance Main	4.12 Ohms	Mounting	Rigid Base
Motor Orientation	Horizontal	Drive End Bearing	Ball
Opp Drive End Bearing	Ball	Frame Material	Rolled Steel
Shaft Type	T	Shaft Diameter	1.125 in
Assembly/Box Mounting	F1/F2 CAPABLE		
Outline Drawing	SS600198-100	Connection Drawing	EE7308

This is an uncontrolled document once printed or downloaded and is subject to change without notice. Date Created:07/01/2021

DASH NO.	4			3				2		1
	B	C	E	2E	2F	2FF	BA	BS	MOUNTING	
100	6.50	12.25	3.75	7.50	4.50	5.50	2.75	4.15	F1 OR F2	182T
200		13.25						5.15		184T

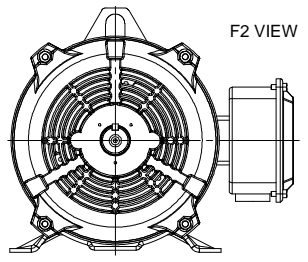
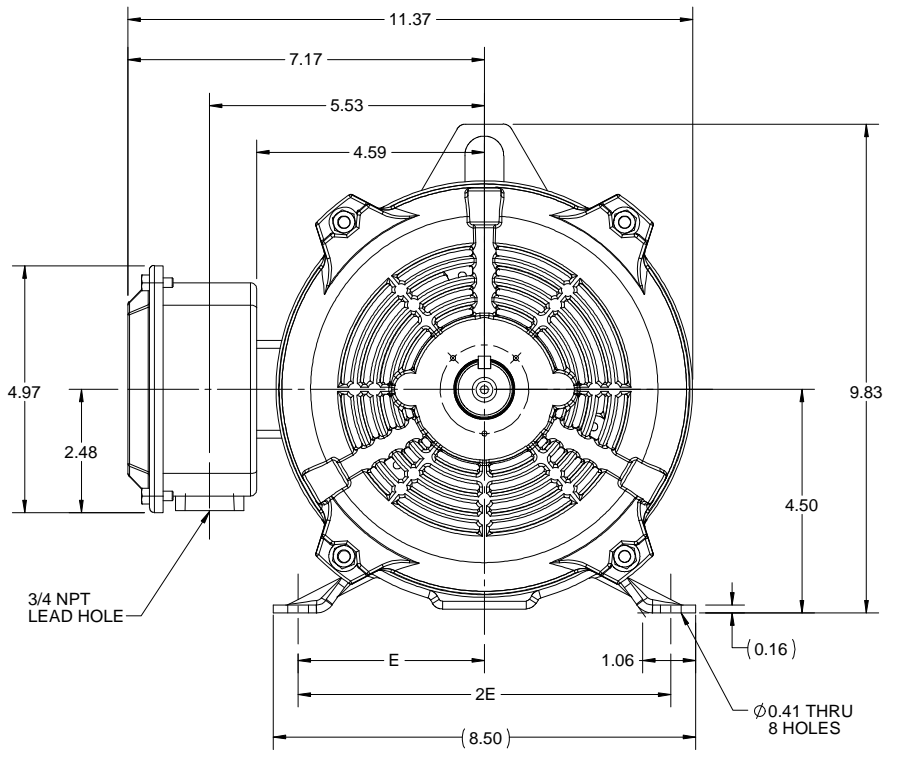
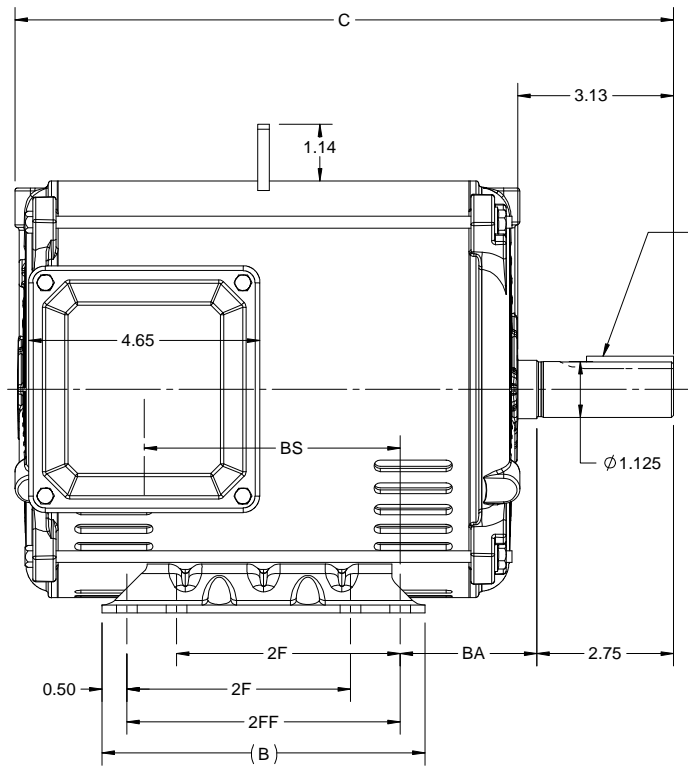

DRAWING REVISION E	REVISION BY ASHOK N	REV DATE/© DATE 19/11/2020
ECO ECO-0195163	APPROVED BY GNK	DATE 19/11/2020
ECO DESCRIPTION DRAWING UPDATED		
<small>COPYRIGHT (PER REVISION DATE) REGAL BELOIT AMERICA, INC. ALL RIGHTS RESERVED. PROPRIETARY AND CONFIDENTIAL INFORMATION - THIS DOCUMENT IS THE PROPERTY OF REGAL BELOIT AMERICA, INC. (OWNER) AND CONTAINS OWNER'S PROPRIETARY INFORMATION. ANY PERSON, CORPORATION OR OTHER FIRM RECEIVING IT IS DEEMED, BY RECEIVING IT, TO AGREE THAT IT, AND/OR ANY PART OF IT, SHALL NOT BE DISCLOSED TO ANY PERSON, CORPORATION OR OTHER ENTITY, DUPLICATED, AND/OR USED, EXCEPT AS EXPRESSLY APPROVED IN WRITING IN ADVANCE BY OWNER. THIS DOCUMENT SHALL BE RETURNED TO OWNER UPON REQUEST. IT MAY BE SUBJECT TO CERTAIN RESTRICTIONS UNDER APPLICABLE EXPORT CONTROL LAWS AND REGULATIONS.</small>		

PRIMARY DIMENSIONS ARE INCH
mm DIMENSIONS IN [BRACKETS]
ARE FOR REFERENCE ONLY

DRAWN BY PRIYA	Regal Beloit America, Inc.
DATE 12/03/2018	
APPROVED BY SBD	DESCRIPTION OUTLINE 182/184T FR -NEMA-ODP RS
DATE 12/03/2018	MATERIAL
REFERENCE	PROCESS/FINISH
THIRD ANGLE PROJECTION	SIZE B
	DRAWING NUMBER SS600198
	SHEET 1 OF 1

EE7308

THREE PHASE
DUAL VOLTAGE MOTOR

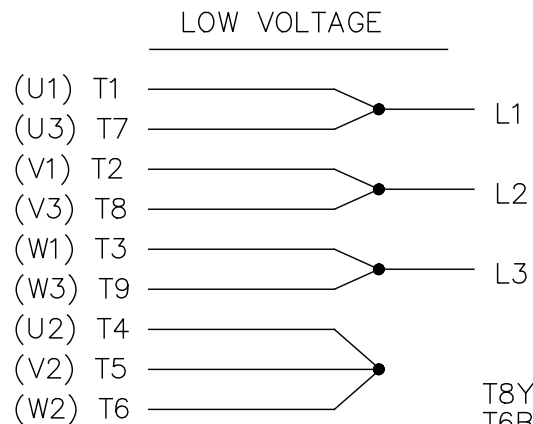
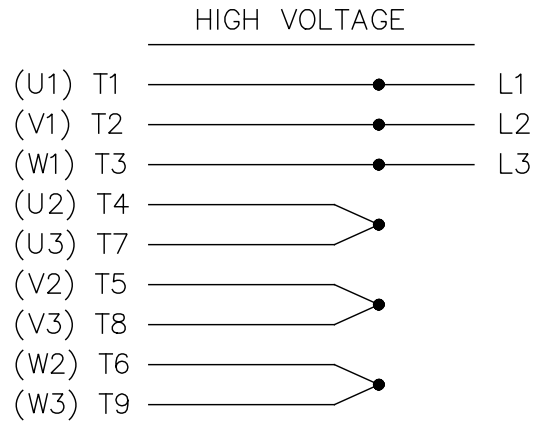

VIEW OF TERMINAL END

REF.
WINDING DIAGRAM

T8Y, T2Y, T2BL, T4BX, T2EC, T2G
T6BZ, T2B, T6BL, T4AV, T6B, T4B

OPTIONAL CORD
CONNECTION

L1 — WHITE
L2 — RED
L3 — BLACK

NO.	REVISION	BY & DATE	CHK	ANG	TOLERANCES UNLESS SPECIFIED		FINISH	DRAWN RM 11/20/1990				
					DEC.	INCHES						
5	CHG TO REGAL LOGO	SL 09/10/2015	AB					CHK ML 11/21/1990				
4	REVISED IEC NOTATIONS	MSG 11/15/2011	CMN	.X	±.1			APPD SAS 04/24/2003				
3	ADDED IEC NOTATIONS... (U1), (V1) ETC. MU95194	MSG 5/10/2010	MJS	.XX	±.02		TITLE CONNECTION DIAGRAM	SCALE 1=1				
2	ADDED THE OPTIONAL CORD CONNECTION MU46318	RDH 04/24/2003	DRS	.XXX	±.005		3Ø - DUAL VOLTAGE MOTOR	REF				
1	REDRAWN	RM 11/20/1990		.XXXX	±.0005		MAT'L.	FMF				
					±7'30"			PREV				
THIS DRAWING IN DESIGN AND DETAIL IS OUR PROPERTY AND MUST NOT BE USED EXCEPT IN CONNECTION WITH OUR WORK ALL RIGHTS OF DESIGN AND INVENTION ARE RESERVED THIS IS AN ELECTRONICALLY GENERATED DOCUMENT - DO NOT SCALE THIS PRINT							RFP	CAD FILE ee7308	SIZE A	DRAWING NO. EE7308	PAGE OF 5	REV. 5
							DIST WP					



Regal Beloit America, Inc.



P.O. BOX 8003
 WAUSAU, WI 54401-8003
 PH. 715-675-3311

CERTIFICATION DATA SHEET

DATA VOLTS: 460

CUSTOMER P.O. #:
 REFERENCE MODEL #: 182T1DBD026
 CAT #: GT0010A
 CUSTOMER PART #:
 MOUNTING: F/H2 CAPABLE

TYPICAL MOTOR PERFORMANCE DATA

HP	KW	3	2.2	1800	1770	182T	DP	TDB	L	A			
FL EFF	89.5	3/4 LD EFF	89.5	LINE OR INVERTER	DUTY	CONT	INSL	S.F.	AMB	ELEV.			
FL PF	77.5	3/4 LD PF	70.0	1/2 LD EFF	88.0	GTD EFF	F	1.15	40	3300			
LR AMPS @ 480 V	35.0	200-230/460V/180/380	8.8-8/4&8 8/3.4	1/2 LD PF	57.0	89.5	SO CAGE INV RATED						
FL TORQUE	9.0 LB-FT	LR AMPS @ 480 V	20.0	LR TORQUE	222%	29.0 LB-FT	322%	F.L.RISE (°C)	35				
SOUND PRESSURE @ 3 FT.	61 DBA	POWER	0.40 LB-FT ²	MAX. LOAD WK ⁴	20 LB-FT ²	SAFE STALL TIME	20 SEC.	STARTS/HOUR	2	APROX. MOTOR WGT			
DE BRACKET TYPE	STANDARD	ROTOR WK	20	SEVERE DUTY	NO	HAZARDOUS LOCATION	NONE	DRIP COVER	YES	SCREENS	NONE	PAINT	BLUE (ENAMEL)
BEARINGS	DE CODE	SHAFT TYPE	T	SPECIAL DE	NONE	SPECIAL ODE	NONE	SHAFT MATERIAL	1045 HOT ROLLED (C-204)	FRAME MATERIAL	ROLLED STEEL		
DE BALL	6203	PROTECTORS	NOT	BRG RTD's	NONE	THERMISTORS	NONE	CONTROL	FALSE	SPACE HEATERS	NA		
RT (ohms/ph)	2.334	WDS RTD's	NONE	BRG RTD's	NONE	Xm (ohms/ph)	118.125	VIBRATION (in/sec)	0.150	FLOAT ODE			
R1 (ohms/ph)	1.37	X1 (ohms/ph)	5.387	X2 (ohms/ph)	5.387	Xm (ohms/ph)	118.125	VIBRATION (in/sec)	0.150	FLOAT ODE			

*** SUPPLEMENTAL INFORMATION ***

INVERTER TORQUE:	CONSTANT 21/VARIABLE 10:1
INV. HP SPEED RANGE:	NONE
ENCODER:	NONE
BRAKE:	NONE
FT-LB:	NA
VOLTAGE:	NONE
UL: V - DIMENS/CONST UL REC	NONE

FORM 3351 REV 4 227/06

PREPARED BY: VINAIAK VERATE
 DATE: 9/22/2020

Data Sheet

182TDBD6026



Submital
Data @ 460 V

Date: 9/20/2020

Customer:

Attention:

Submitted by:

VINAYAK VERATE

Motor Load Data

Load	0%	25%	50%	75%	100%	115%	125%	LR
Current (Amps)	2.30	2.40	2.80	3.3	4.0	4.5	4.8	35.0
Torque (ft-lb)	0.00	2.20	4.4	6.7	9.0	10.3	11.3	20.0
RPM	1800	1790	1785	1776	1770	1,762	1760	0
P.F. (%)	7.2	81.5	88.0	89.5	89.5	89.5	89.5	48.0

Motor Speed Data

	LR	Pull-Up	BD	Rated	Idle
Speed (RPM)	0	900	1550	1770	1800
Current (Amps)	35.0	30.0	18.0	4.0	2.30
Torque (ft-lb)	20.0	17.0	29.0	9.0	0.00

Information Block

HP	3.0			
Sync. RPM	1800			
Frame	182			
Enclosure	DP			
Construction	TDB			
Voltage	208-230/400#190/380 V			
Frequency	60 Hz			
Design	A			
LR Code letter	L			
Service Factor	1.15			
Temp Rise @ FL	35 °C			
Duty	CONT			
Ambient	40 °C			
Elevation	3,300 feet			
Rotor/Shaft wk ²	0.40 Lb-Ft ²			
Ref Wdg	HA31124028 NONE			
Sound Pressure @ 1M	61 dBA			
VFD Rating	CONSTANT 2:1/VARIABLE 10:1			
Outline Dwg	SS600198-182T			
Conn. Diag	EE7308			
Additional Specifications:				
0				
0				
	EQUIV CKT (OHMS / PHASE)			
R1	R2	X1	X2	Xm
2.3340	1.3700	5.3870	5.3870	118.1250

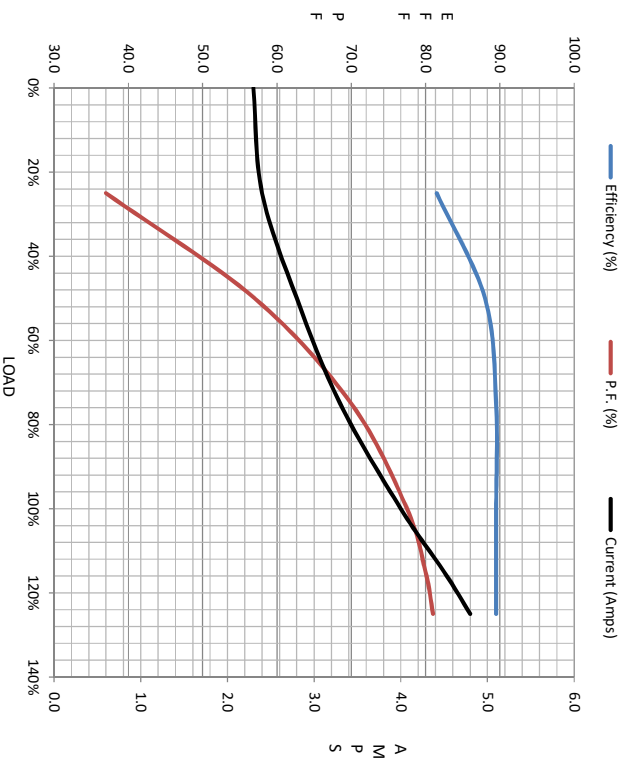

Speed - Torque Curve

